

**Exporting California Navel Oranges to Australia 2009 – 2010
Protocol for the 2009/10 Shipping Season
“8-point Plan”**

1. At least two technical employees from each packing facility that will be cutting fruit for Australia must attend training on how to cut fruit and detect bean thrips. The training will be provided by the County Agricultural Commissioner’s Office, the University of California, or APHIS. Records of personnel trained will be maintained at the packing facility.
2. Maps of grower fruit lot locations are to be kept at the pack house for inspection by regulatory personnel. The lot designation must be maintained for the entire season.
3. Within 30 days of harvest, 150 fruit per grower lot must be cut looking for bean thrips. The sampling must be spread over the outer rows on all 4 sides of the block. For fruit harvested before November 30, the fruit cutting must occur within 15 days of harvest. Records must be kept at the pack house to show fruit cutting results. If bean thrips are found during orchard cull cutting, the lot is ineligible for certification to Australia.
4. The packing house must bring the temperatures of the sweat rooms to at least 65 degrees F for the last eight hours immediately before fruit immersion or washing OR the fruit must be fumigated in the sweat room or other chamber with either Evergreen or Turbocide Gold. Records including chemical name, application rate and holding time must be maintained.
5. Packing houses must inspect and cut 150 culled fruit per grower lot during packing. Detection would eliminate that grower lot from export to Australia. Records must be kept to show the packing house cutting results.
6. Each carton of fruit must contain the grower lot number or the pallet tag must show the grower lot number(s) to allow for traceback should bean thrips be intercepted in packed fruit. The grower lot number must be maintained throughout the season.
7. Phytosanitary inspection will be of all fruit in a sufficient number of randomly chosen cartons to ensure a visual inspection of 600 pieces of fruit. The 600-fruit sample will be based on a representative sample of the grower lots in the shipment. A minimum of 10 fruit per carton will be cut to look for bean thrips. The detection of bean thrips will remove the grower lot from the Australia program for the remainder of the season.

8. Penalties:
- a. One (1) live bean thrips find during orchard fruit cutting, cull cutting, APHIS phytosanitary inspection, AQIS Pre-clearance, or Australian port of entry inspection removes the grower lot for the remainder of the season.
 - b. Should bean thrips be found in 3 different grower lots at phytosanitary inspection, AQIS preclearance inspection, or Australian port of entry inspection, the grower or ranch will be suspended until an investigation has been completed (within a 24-hour period, excluding Sundays and holidays) and corrective actions taken to the satisfaction of USDA, APHIS. The investigation would include cultural practices and compliance with the Australia Citrus Work Plan. Corrective action(s) recommended as a result of the investigation must be completed and in place before reinstatement of the grower to export citrus to Australia. Corrective Actions may include the grower/packer preparing Standard Operating Procedures (SOP's) in writing stating how the problem will be corrected and clearly stating what action is taken to prevent the problem/pest finding from reoccurring, or increasing the number of culls cut to 300. This would be determined on a ranch-by-ranch basis depending on the ownership of the citrus. Serious reoccurring problems or deliberate violation of the work plan may result in suspension for the season.
 - c. Packing houses will not be subject to penalties unless there is evidence that a practice is taking place that is detrimental to the program. Corrective actions and/or SOP's may be required to prevent reoccurrence of the problem/violation, before removing the temporary suspension. Serious reoccurring problems or deliberate violations of the work plan may result in suspension for the season.

DEFINITIONS:

Grower Lot = a contiguous planting (orchard) which is identifiable by physical boundaries (farm roads, waterways, or highways). The same lot numbers are marked on all cartons of citrus originating from this same orchard. This same lot number as assigned by the grower at the beginning of the season before harvest will remain with the lot for the rest of the season.

Grower Block = group of several lots in the same geographic area registered under the same grower. The grower lot groups making up the block may or may not be contiguous. The grower blocks will be in the same geographic vicinity (see diagram)

Grower Ranch = may be a single large grower lot or made up of several grower blocks in geographic vicinity. The ranch blocks may or may not be contiguous, and the grower

ranch area must be geographically definable. In the case of a small grower, one (1) grower lot could be considered as a grower ranch. Large growers may have multiple ranches separated geographically by greater distances such as 2-10 miles. Temporarily suspending a grower ranch pending investigation results rather than suspending all grower ranches is appropriate.

Grower Lot/Carton Numbering. Growers may break large blocks into many smaller lots as long as they do so at the beginning of the season. Renaming grower lots, blocks, or ranches after the season has begun is not permitted. Changing grower lots using different lot numbers/names based on separate harvest or shipping dates is prohibited.

October 14, 2009

ca az navels to au 8-point plan with penalties final 2009-2010.doc

Grower Ranch, Block, Lot Examples

RANCH

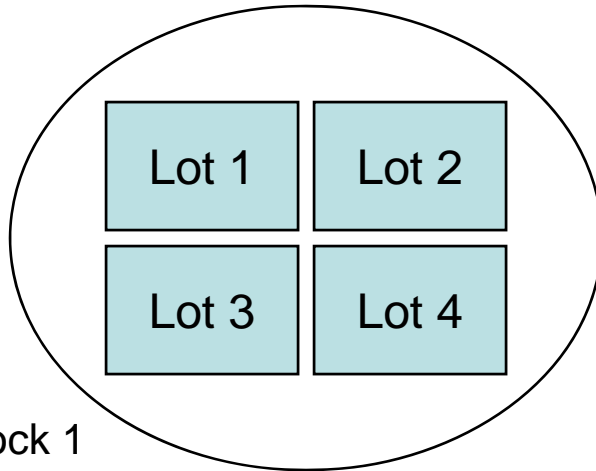

Block 1

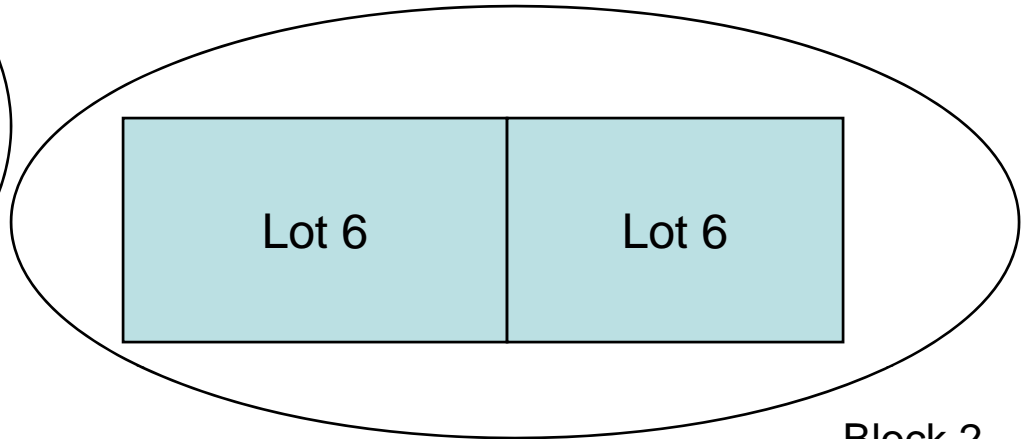

Block 2

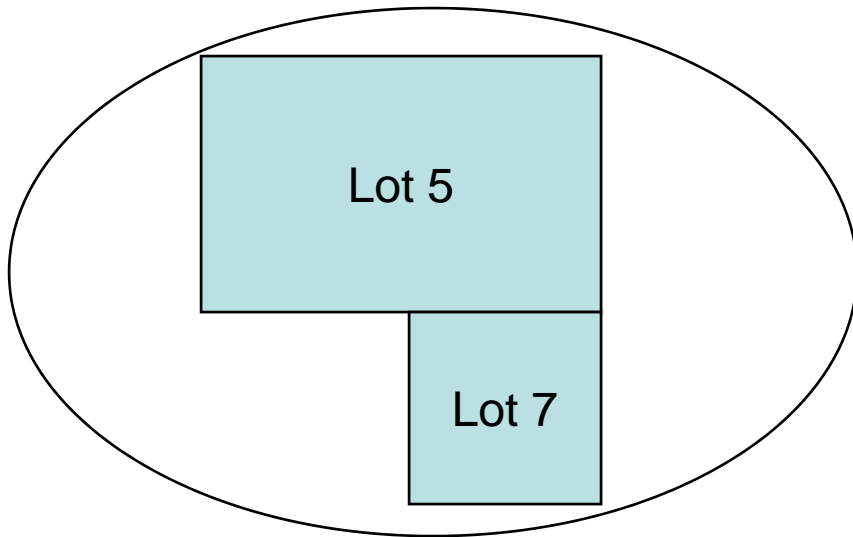

Block 3

Block 1. All lots in this block are separated by paved roads and are not contiguous

Block 2. All lots in this block are separated by farm dirt road and can use the same lot number

Block 3. Lots in this example are separated by a farm dirt road and can have different lot numbers providing the physical separation by the road. This would require separate cutting for each separate lot.

This example represents a ranch, the total planted acreage represented by the color squares could be considered all one block or lot. The example allows for separate lots/blocks providing they are physically separated. For example a 20 acre lot with no physical barriers can not be broken into separate lots.